

H-1X

Quick Setup Instructions

WARNING: Electrical and plumbing connections need to be made by a qualified service person who will comply with all available Federal, State and Local Health, Electrical, Plumbing and Safety codes.

H-1X FRONT VIEW

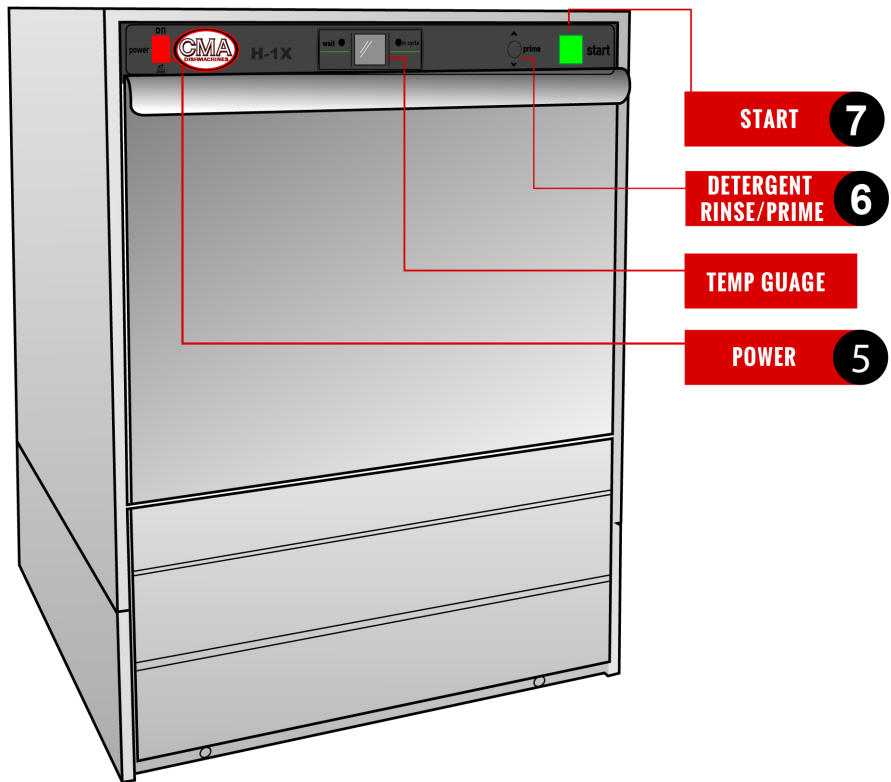

BOOSTER FILL PROCEDURE

1. **DO NOT TURN THE DISHMACHINE POWER SWITCH ON.**
2. Turn the water supply to the machine on.
3. Turn the breaker or disconnect on.
4. PRESS and HOLD the dishmachine **GREEN** start switch for 3 seconds to activate the fill solenoid.
5. Continue to hold the start switch until water enters the wash tank.
6. Release the start switch.
7. Booster pre-fill is complete.



The chemical pumps must be primed (using the prime switch) before the dishmachine is operated .

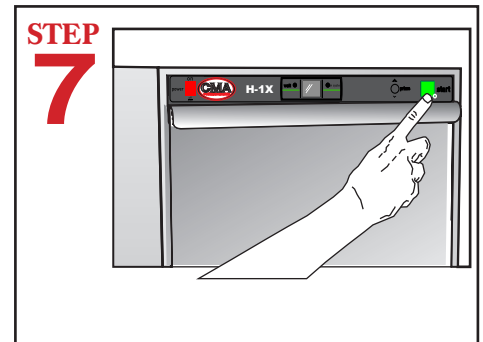

Push the "START" button to start the dishmachine cycle.



an Ali Group Company



The Spirit of Excellence