



## Installation & Operation

High Temp Upright Door Machines  
Drain Water Tempering Kit  
PN13475.02 Factory Kit  
PN13476.02 Field Kit

### ***Drain Water Tempering Kit - Initial Installation Instructions***

*for Factory Installed Drain Water Tempering Kits*

1. Machine ships with tee, elbow fitting and CMA Drain Water Tempering (DWT) valve inside the machine.
2. The DWT can be installed with or without the elbow as needed.



2. DWT with elbow installed before the tee with black plug installed.

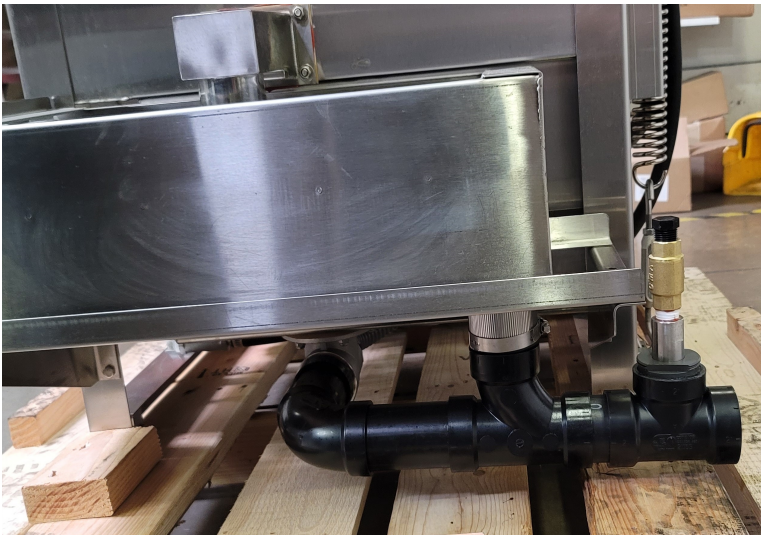

2. DWT without elbow installed before the tee with black plug installed.



3. Remove black plug.

4. Connect cold water line to the in-line check valve. Installer responsible for water connection. Cold water connections not supplied by CMA Dishmachines.
5. Turn on cold water and check for leaks.

Drain Water Tempering Valve Assembly (Effective 03-2023)  
PN13475.02 Factory Installed Kit  
PN13476.02 Field Installed Kit

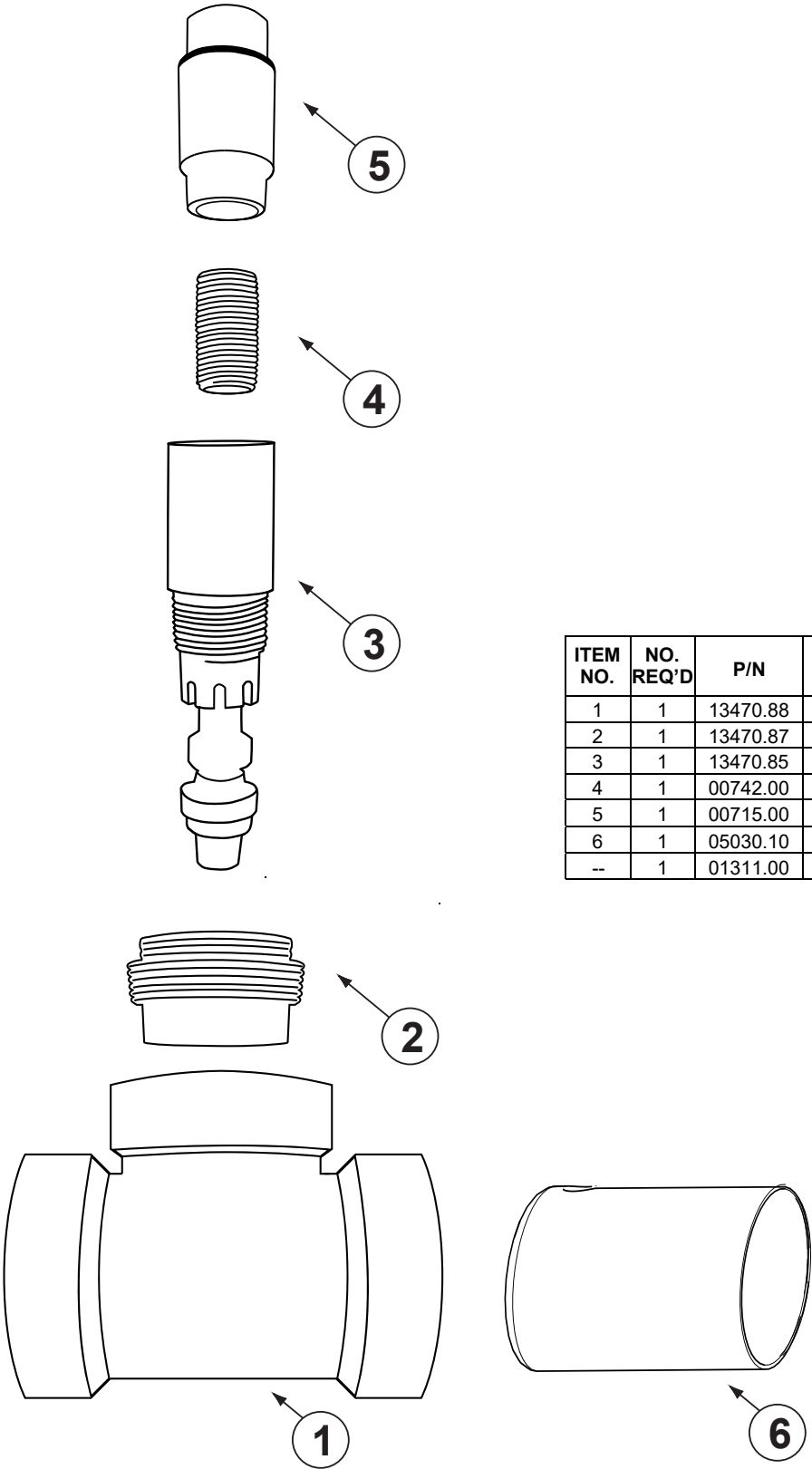

ITEM NO.	NO. REQ'D	P/N	DESCRIPTION
1	1	13470.88	2 ABS Tee S x S x MIP
2	1	13470.87	DTV Adapter 2" X 3/4"
3	1	13470.85	Drain Water Tempering Valve
4	1	00742.00	Nipple Brass 1/2 x 1-1/2
5	1	00715.00	1/2 Ball Check Valve
6	1	05030.10	2 x 3 ABS Tubing
--	1	01311.00	90 Degree ABS Street Elbow - not shown