

# SERVICE BULLETIN

**Date:** FEBRUARY 2009  
**Log Number:** 119  
**Motors Affected:** PN 00201.00, PN 00201.85  
**Subject:** MOTOR IMPELLER/SEAL SERVICE KIT PN 03223.00

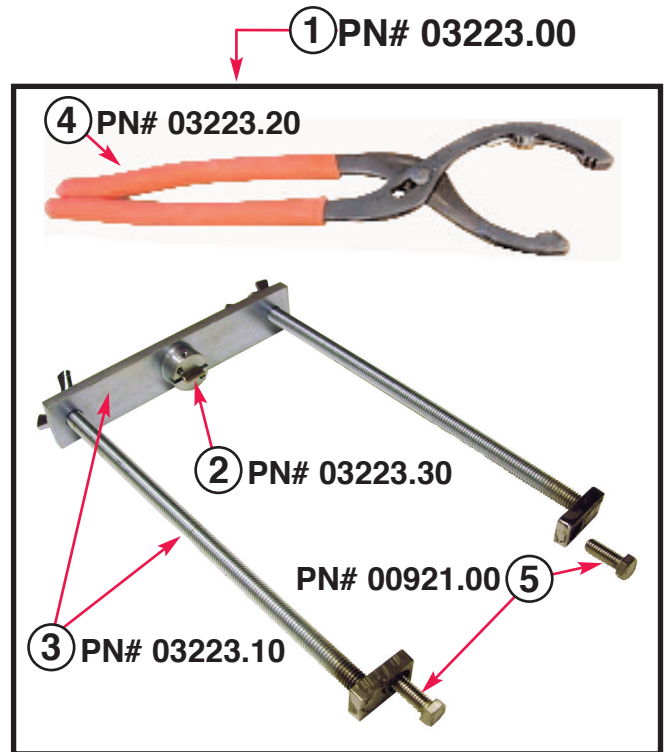
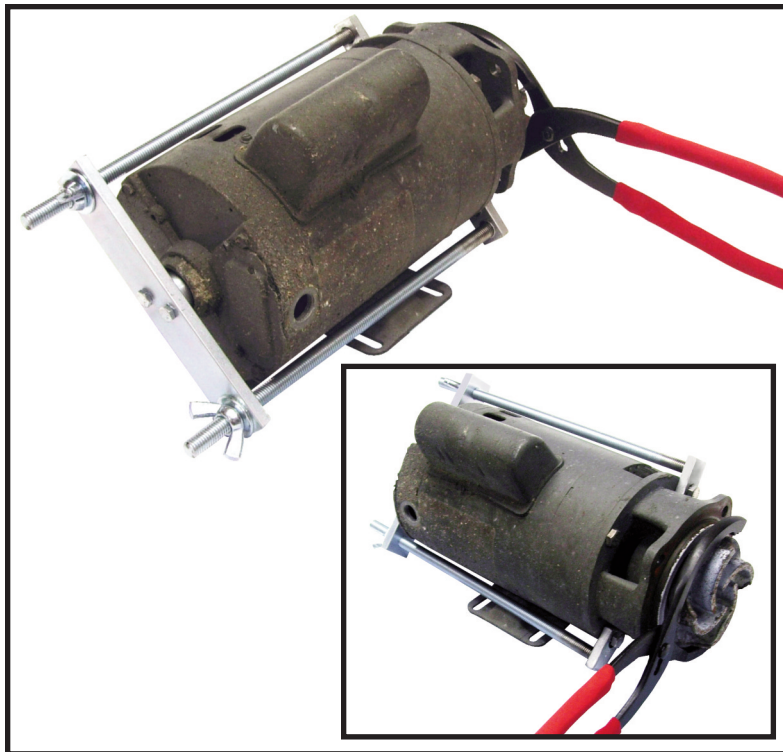

## Motor Impeller Removal Kit Instructions

1. Remove two bolts from the pump base. Don't discard them.
2. Remove the motor shaft cover in the back of the motor. The motor shaft will be exposed.
3. Insert Motor Shaft Blade P/N 3223.30 and tighten the set screw.
4. Align the blade with the motor shaft slot.
5. Adjust wing nut just enough to engage Impeller/Pump Service Jig P/N 3223.10 with the pump base on the other side of the motor.
6. Attach Impeller/Pump Service Jig P/N 3223.10 to the pump base using two hex head bolts P/N 921.00 (only hand tighten them) instead of removing bolts. Tighten wing nuts.
7. Turn impeller counter-clockwise with Impeller/Pump Seal Wrench P/N 3223.20 and unscrew it from the shaft.  
It may be necessary to spray impeller with WD-40 if it will not break loose with turning pressure.

ITEM NO.	NO. REQ'D	DESCRIPTION
1	1	P/N 3223.00 Motor Impeller/Seal Kit
2	1	P/N 3223.30 Motor Shaft Blade
3	2	P/N 3223.10 Impeller/Pump Service Jig
4	1	P/N 3223.20 Impeller/Pump Seal Wrench
5	1	P/N 0921.00 3/8"-16X3/4" Hexhead Bolt



12700 KNOTT STREET  
 GARDEN GROVE, CALIF. 92841  
 800-854-6417 • 714-898-8781 • FAX 714-895-2141  
 www.cmadishmachines.com

